

## 1.1 Typical problems

- numbers shown below refer to the Method Statements listed in Section 2

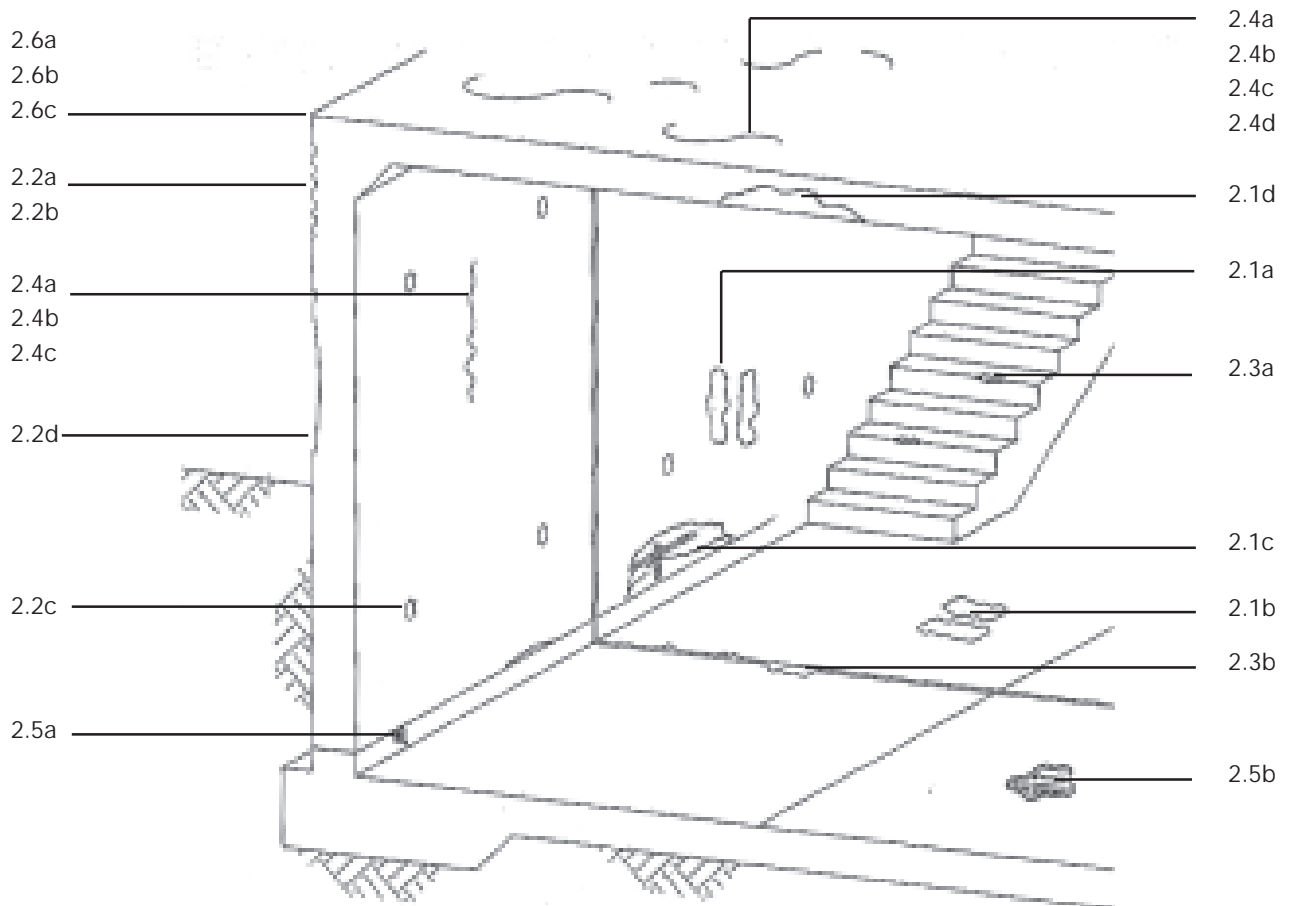

### Key

#### 2.1 - Honeycombing

- |   |                        |
|---|------------------------|
| <i>a</i> - Shallow : vertical or overhead | <i>Renderoc TGXtra</i> |
| <i>b</i> - Shallow : horizontal           | <i>Renderoc SXtra</i>  |
| <i>c</i> - Deep : all orientations        | <i>Renderoc LAXtra</i> |
| <i>d</i> - Large area : all orientations  | <i>Renderoc SPXtra</i> |

#### 2.2 - Surface imperfections

- |  |                                |
|--|--------------------------------|
| <i>a</i> - Pinholes : 0 - 3 mm deep          | <i>Rend FC/N'mortar FC</i>     |
| <i>b</i> - Blowholes : 3 - 10 mm deep        | <i>Rend BF2/N'mortar FC(B)</i> |
| <i>c</i> - Tie-bolt holes (up to 100 mm dia) | <i>Conbextra GP</i>            |
| <i>d</i> - General reprofiling               | <i>Various</i>                 |

#### 2.3 - Corner repairs

- |                                     |                               |
|-------------------------------------|-------------------------------|
| <i>a</i> - Stair treads and nosings | <i>Nitomortar S</i>           |
| <i>b</i> - Joint arrises            | <i>Nitomortar S + sealant</i> |

#### 2.4 - Cracks

- |  |                                |
|--|--------------------------------|
| <i>a</i> - Moving : 0.25 - 3 mm                  | <i>Nitofill UR63</i>           |
| <i>b</i> - Non moving : < 0.25 mm                | <i>Rend TGXtra/N'mortar FC</i> |
| <i>c</i> - Non moving : 0.25 - 3 mm (general)    | <i>Nitofill EPLV</i>           |
| <i>d</i> - Non moving : 0.25 - 3 mm (horizontal) | <i>Nitofill EPLV</i>           |

#### 2.5 - Leaks

- |                             |  |
|-----------------------------|--|
| <i>a</i> - Leaking cracks   | <i>Nitofill WS60 + Nitofill UR63</i>   |
| <i>b</i> - Leaking concrete | <i>Renderoc Plug, then Nitofill WS60 + Nitofill UR63, then general reprofiling</i> |

#### 2.6 - Enhancing concrete cover

- |  |                       |
|--|-----------------------|
| <i>a</i> - Uniform cementitious finish           | <i>Brushbond</i>      |
| <i>b</i> - Decorative and protective coating     | <i>Dekguard S</i>     |
| <i>c</i> - Decorative and crack-bridging coating | <i>Dekguard E2000</i> |